

HEAT EXCHANGER CC901F-RH9 & CC901F-WL*-RH9 AIR TO AIR FLUSH MOUNT MODEL

Model	Weight (lbs)	Rating @ 20°C ΔT (BTU/hr)	Amps Current Draw at 115 volts AC	Fan size	Dimensions-Inches (HxWxD)
CC901F-RH9	23 lbs	4,280	0.98	2x6"	22 x 20 x 8
Efficiency: 62.7 Watts / °C ΔT based on average internal cabinet temperature					

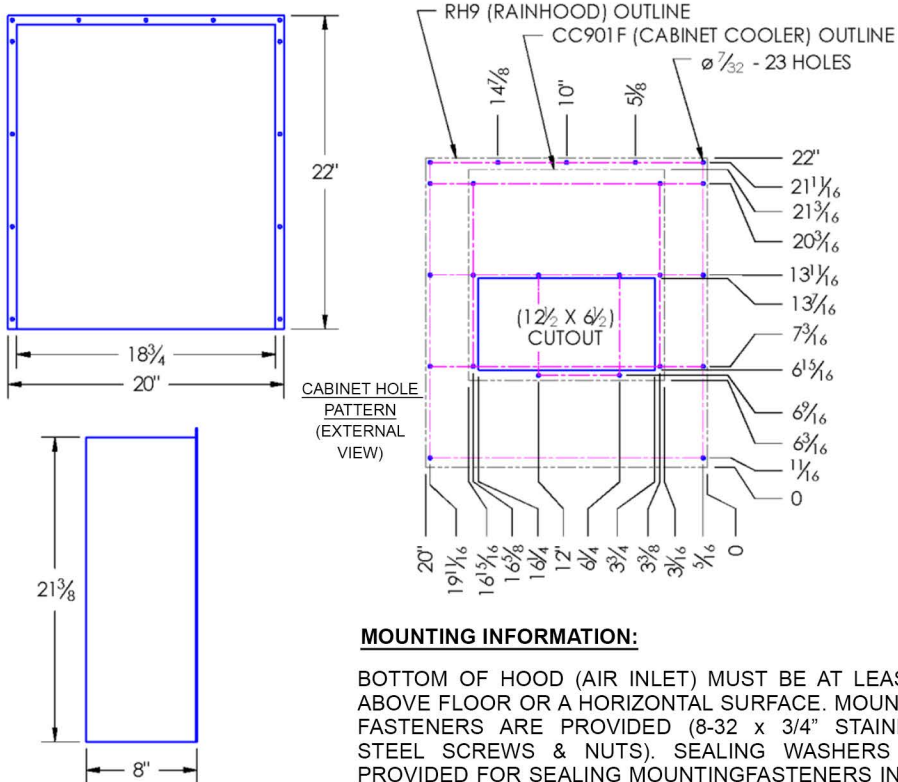

MOUNTING INFORMATION:

BOTTOM OF HOOD (AIR INLET) MUST BE AT LEAST 6" ABOVE FLOOR OR A HORIZONTAL SURFACE. MOUNTING FASTENERS ARE PROVIDED (8-32 x 3/4" STAINLESS STEEL SCREWS & NUTS). SEALING WASHERS ARE PROVIDED FOR SEALING MOUNTINGFASTENERS INSIDE YOUR ENCLOSURE.

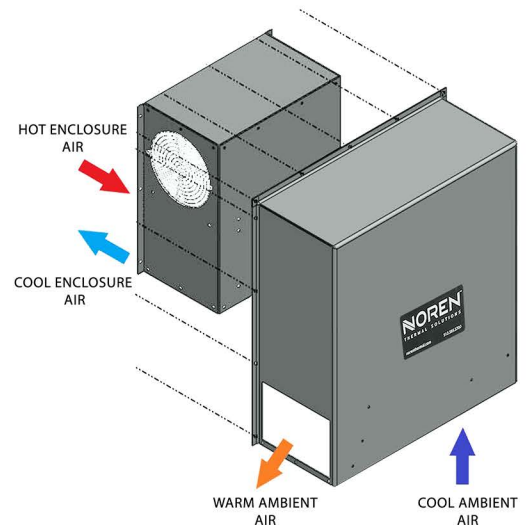

PRODUCT SPECIFICATIONS

- Unit and options are UL Listed (SA9567) for TYPE 3R or TYPE 4 environments
- CC901F Rated cooling: 1,254 Watts at 20°C ΔT (62.7 W/°C, mounted to an uninsulated 72" x 36" x 24" cabinet)
- Cabinet cooler with hood design for surface mounting on outside of cabinet
- Housing and hood are aluminum (Standard color). Stainless steel is available
- Equipped with mounting gasket to maintain the NEMA / TYPE 3R or 4 integrity of your cabinet
- Pressure tested to insure liquid tight seal
- *Optional "WET LOCATION FAN" (-WL) is required for TYPE 4 (HOSE DOWN)**
- Internal 6-ft. power cord with 3-prong plug is standard for AC powered units
- Available with VAC (115 & 230) and VDC (12, 24, & 48) fans.
DC powered units include junction box, consult website
- For Vertical mounting only (as shown)
- Optional: inlet air-filter kit available upon request
- For design, quote, and sizing assistance: call (512) 595-5700

*Subject to change without notice



CC901F-RH9 & CC901F-WL*-RH9 Air to Air Flush Mount Model



205 s. Edmond Street
Taylor, TX 76574
(512) 595-5700.
www.norenthermal.com

**CC901F-RH9 &
CC901F-WL*-RH9**

CCS-PBD-7.2.2-883347-C